

## **The Thork-Lift - quality at working height**

The Thork-Lift can transport and lift a skid to the right ergonomic working height, and is very gentle to surroundings, skids and goods. The Thork-Lift has an elegant design with rounded corners.

The design prevents industrial injuries and strain on the user - focus is put on safety and ergonomic working conditions of the user. As an example, the ergonomically correct shape of the handle ensures a relaxed hold for the user.

High quality is ensured through an extended test program and in cooperation with experts in Health and Safety.



## Technical Specifications

Loads of 3300 lbs. can be transported and lifted up to 18.5 inches with the highlifter. From 18.5 inches the lifting capacity is 2200 lbs.

Optimum user-friendliness

- low own weight
- central location of all control buttons
- ergonomic handle

Long operating life and low maintenance costs

- reliable cylinder construction
- strong construction
- use of quality materials

Optimum stability

- low overall height
- fork length of 47"
- supporting feet at steering wheel
- tandem wheels on scissors legs



The manual highlifter needs very low power for the pump function and has foot protection and neutral position.



Optional extras: remote control, level control and brake.



The tandem wheels have a brake effect and are not hostile to the floor.



Ergonomic handle ensures the user a relaxed hold.



Level control (optional extra) ensures a constant working height.

Product (measured in inch)	TL-M					TL-E				
	3300*					3300*				
Capacity in lbs.	3300*					2200				
Lifting height	h <sub>3</sub>	19.5	23.5	31.5	31.5	31.5	19.5	23.5	31.5	31.5
Fork length	l	27.5	35.5	47	60	79	27.5	35.5	47	60
Overall height	h <sub>1</sub>	21.25					21.25			
Fork span	b <sub>5</sub>	19, 21.25, 27					19, 21.25, 27			
Length without forks	l <sub>2</sub>	14					17.75			
Overall length	l <sub>1</sub>	41.5	49.5	61.25	74	92.75	45.25	53.25	65	77.5
Overall height with handle	h <sub>4</sub>	48.25					47			
Lowered height	h <sub>13</sub>	3.25					3 1/4			
Fork width	e	6.5					6.5			
Turning angle of the wheels		230°					180°			
Gangway	A <sub>st</sub>	72 (pallet: 47 x 31.5)					74.5 (pallet: 47 x 31.5)			
Lifting speed with/without load		0.4" / 1.4" per pump					2" / 3.2" per sec.			
Lifting speed normal/quick		Without load 3.5" per sec.					With/without load: 2.75" / 2" per sec.			
Lowering speed		Without load 3.5" per sec.					With/without load: 2.75" / 2" per sec.			
Pump motor		0.9 kW 12 V					0.9 kW 12 V			
Weight with 47" forks (no battery)		209 lbs.					229 lbs.			

\* The capacity changes from 3300 to 2200 lbs. at the lifting height 18.5".

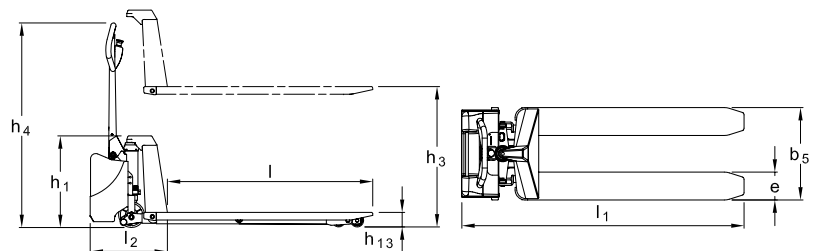

Can be marked with name/department.



Available as manual, electric and stainless.



Patented cylinder construction gives low overall height.

We also offer tailor-made solutions.

Please ask for further information or visit [www.interthor.com](http://www.interthor.com)